

DIN 934 AD2000-W2– sim. ISO 4032

Nakrętki sześciokątne

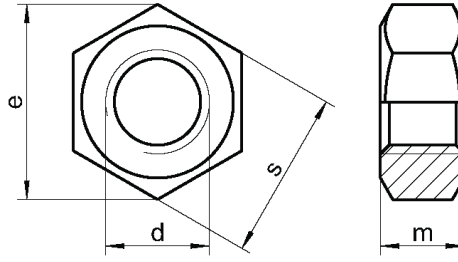

d	m min.	s	e	⬡
M6	4,70	10	11,05	10
M8	6,14	13	14,38	13
M10	7,64	17	18,90	17
M12	9,64	19	21,10	19
M14	10,30	22	24,49	22
M16	12,30	24	26,75	24
M18	14,30	27	29,56	27
M20	14,90	30	32,95	30
M22	16,90	32	35,03	32
M24	17,70	36	39,55	36
M27	20,70	41	45,20	41
M30	22,70	46	50,85	46
M33	24,70	50	55,37	50
M36	27,40	55	60,79	55

Material	Opakowanie
A2 / A4	500
A2 / A4	200
A2 / A4	100
A2 / A4	100
A2 / A4	100
A2 / A4	50
A2 / A4	50
A2 / A4	50
A2 / A4	25
A2 / A4	25
A2 / A4	25
A2 / A4	10
A2 / A4	10

DIN 934 – sim. ISO 8673

Nakrętki sześciokątne drobnozwojowe

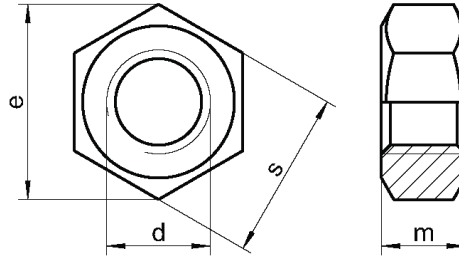

d	m min.	s	e	⬡
M8x1	6,14	13	14,38	13
M10x1	7,64	17	18,90	17
M10x1,25	7,64	17	18,90	17
M12x1,5	9,64	19	21,10	19
M12x1,25	9,64	19	21,10	19
M14x1,5	10,30	22	24,49	22
M16x1,5	12,30	24	26,75	24
M18x1,5	14,30	27	29,56	27
M20x1,5	14,90	30	32,92	30
M20x2	14,90	30	32,95	30
M22x1,5	16,90	32	35,03	32
M24x1,5	17,70	36	39,55	36
M24x2	17,70	36	39,55	36
M27x1,5	20,70	41	45,20	41
M27x2	20,70	41	45,20	41
M30x1,5	22,70	46	50,85	46
M30x2	22,70	46	50,85	46
M36x1,5	27,40	55	60,79	55
M36x3	27,40	55	60,79	55
M42x4,5	32,40	65	71,30	65

Material	Opakowanie
A2 / A4	200
A2 / A4	100
A2 / A4	100
A2 / A4	100
A2 / A4	100
A2 / A4	100
A2 / A4	50
A2 / A4	50
A2 / A4	50
A2 / A4	50
A2 / A4	25
A2 / A4	25
A2 / A4	25
A2 / A4	25
A2 / A4	25
A2 / A4	25
A2 / A4	10
A2 / A4	10
A2 / A4	10

DIN 934

Nakrętki sześciokątne z lewym gwintem

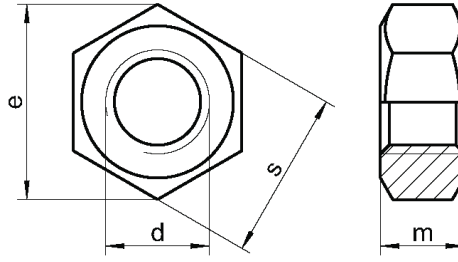



d	m min.	s	e	⬡
M3	2,15	5,5	6,01	5,5
M4	2,90	7	7,66	7
M5	3,70	8	8,79	8
M6	4,70	10	11,05	10
M8	6,14	13	14,38	13
M10	7,64	17	18,90	17
M12	9,64	19	21,10	19
M14	10,30	22	24,49	22
M16	12,30	24	26,75	24
M18	14,30	27	29,56	27
M20	14,90	30	32,95	30
M22	16,90	32	35,03	32
M24	17,70	36	39,55	36
M27	20,70	41	45,20	41
M30	22,70	46	50,85	46

Material	Opakowanie
A2 / A4	100
A2 / A4	100
A2 / A4	100
A2 / A4	100
A2 / A4	100
A2 / A4	100
A2 / A4	50
A2 / A4	50
A2 / A4	25
A2 / A4	25
A2 / A4	25
A2 / A4	25
A2 / A4	25
A2 / A4	10
A2 / A4	10

DIN 934 UNC

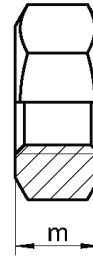
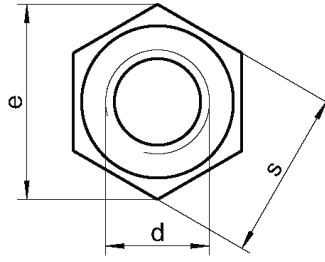
Nakrętki sześciokątne



d	m min.	s	e	gears	
1/4"	5,5	11	12,7	20	11
5/16"	6,5	14	16,2	18	14
3/8"	8,0	17	19,6	16	17
1/2"	11,0	22	25,4	13	22
5/8"	13,0	27	31,2	11	27
3/4"	16,0	32	36,9	10	32
7/8"	18,0	36	41,6	9	36
1"	20,0	41	47,3	8	41

Material	Opakowanie
A2 / A4	500
A2 / A4	200
A2 / A4	100
A2 / A4	100
A2 / A4	50
A2 / A4	50
A2 / A4	25
A2 / A4	25

DIN 934 A2-80 – sim. ISO 4032

Nakrętki sześciokątne

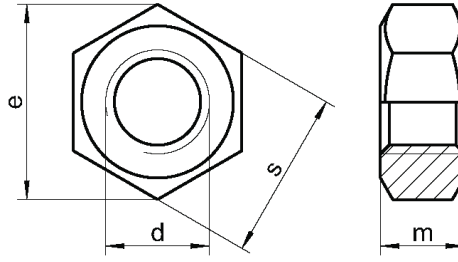



d	m min.	s	e	⬡
M4	2,90	7	7,66	7
M6	4,70	10	11,05	10
M8	6,14	13	14,38	13
M10	7,64	17	18,90	17
M12	9,64	19	21,10	19
M14	10,30	22	24,49	22
M16	12,30	24	26,75	24
M20	14,90	30	32,95	30
M22	16,90	32	35,03	32
M24	17,70	36	39,55	36

Material	Opakowanie
A2	500
A2	500
A2	200
A2	100
A2	100
A2	100
A2	50
A2	50
A2	50
A2	50

DIN 934 – specjalny materiał – sim. ISO 4032

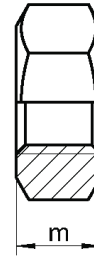
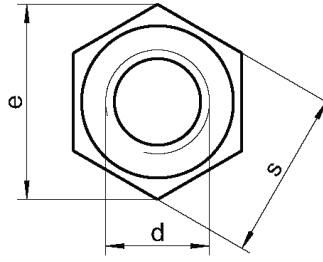
Nakrętki sześciokątne



d	m min.	s	e	
M6	4,70	10	11,05	10
M8	6,14	13	14,38	13
M10	7,64	17	18,90	17
M12	9,64	19	21,10	19
M16	12,30	24	26,75	24
M20	14,90	30	32,95	30
M24	17,70	36	39,55	36
M27	20,70	41	45,20	41
M30	22,70	46	50,85	46

Materiał	Opakowanie
A5 Al BA BB	100
A5 Al BA BB	100
A5 Al BA BB	50
A5 Al BA BB	50
A5 Al BA BB	25
A5 Al BA BB	25
A5 Al BA BB	25
A5 Al BA BB	25
A5 Al BA BB	25

ISO 4032 – sim. DIN 934
Nakrętki sześciokątne

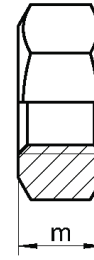
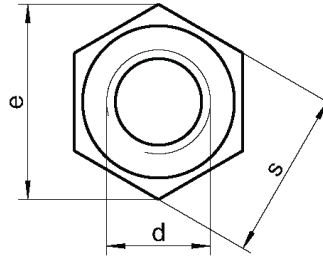

d	m min.	s	e	
M10	8,04	16	17,77	16
M12	10,37	18	20,03	18
M16	14,10	24	26,75	24

Material	Opakowanie
A2 / A4	100
A2 / A4	100
A2 / A4	50