

## DIN 466

### Nakrętki z łbem radełkowanym

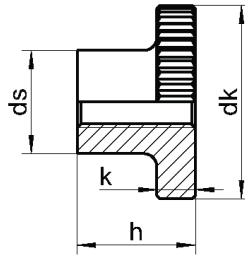
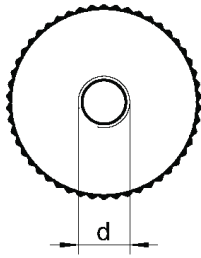

d	dk	ds	h	k
M2,5	11	5	6,5	2,5
M3	12	6	7,5	2,5
M4	16	8	9,5	3,5
M5	20	10	11,5	4,0
M6	24	12	15,0	5,0
M8	30	16	18,0	6,0
M10	36	20	23,0	8,0

Material	Opakowanie
A1	100
A1	100
A1	100
A1	50
A1	50
A1	25
A1	25